

DIRECTIONS FOR USE BUILT-IN SEPARATOR

MODE D'EMPLOI
POUBELLE ENCASTRABLE
'SEPARATOR'

GEBRAUCHSANLEITUNG
EINBAUEIMER 'SEPARATOR'

ISTRUZIONI D'USO
RACCOGLITORE DA INCASSO
'SEPARATOR'

MANUAL DE INSTRUCCIONES
UNIDAD INTEGRADA 'SEPARATOR'

INSTRUCÇÕES DE UTILIZAÇÃO
UNIDADE INCORPORADA
'SEPARATOR'

GEBRUIKSAANWIJZING
INBOUWUNIT 'SEPARATOR'

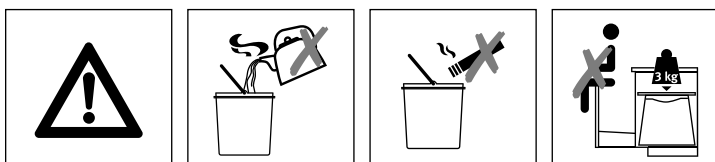

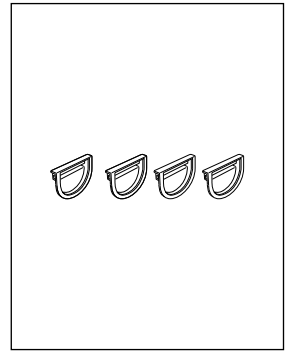
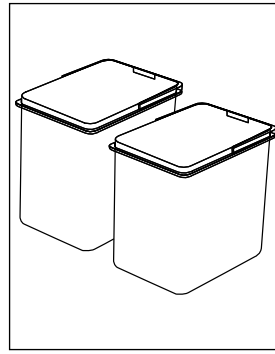
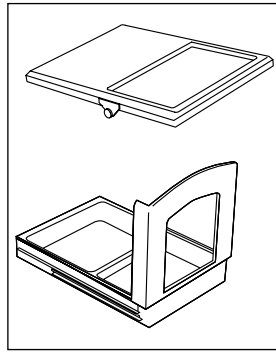
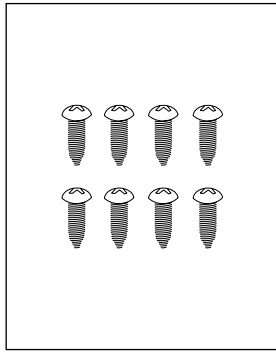
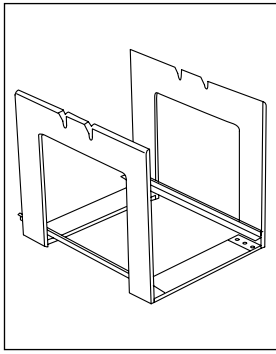

FIXING • FIXATION • BEFESTIGUNG • FISSAGGIO • FIJACIÓN • FIXAÇÃO • BEVESTIGING

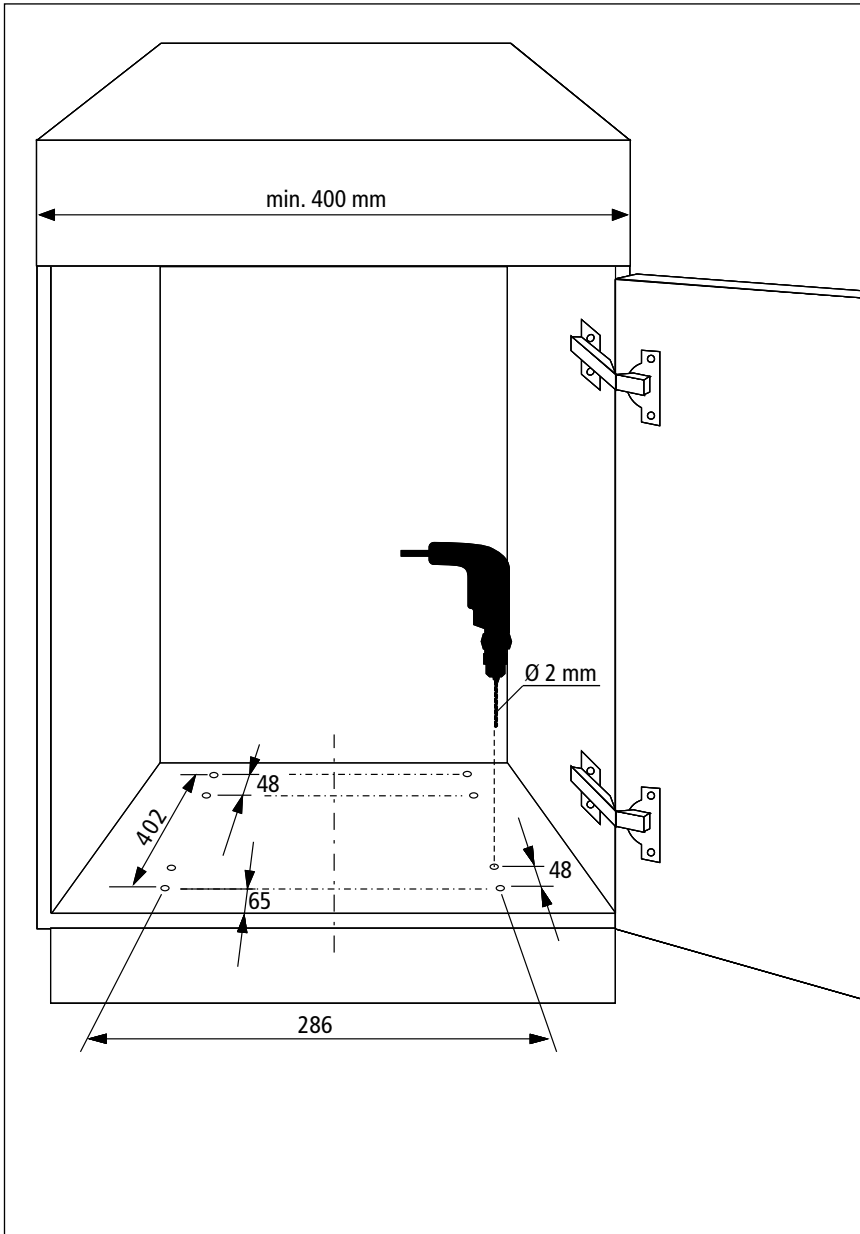

UK USA

Important - Beware not to drill through electric, water or gas pipes

F

Belangrijk - Let op dat u niet in gas-, water-, of elektriciteitsleidingen boort!

D

Belangrijk - Let op dat u niet in gas-, water-, of elektriciteitsleidingen boort!

I

Belangrijk - Let op dat u niet in gas-, water-, of elektriciteitsleidingen boort!

UK USA

Important - Beware not to drill through electric, water or gas pipes

F

Belangrijk - Let op dat u niet in gas-, water-, of elektriciteitsleidingen boort!

D

Belangrijk - Let op dat u niet in gas-, water-, of elektriciteitsleidingen boort!

